



INSTALLATION INSTRUCTIONS

VEHICLE APPLICATION

Year: **2007-10**
Make: **Chevrolet / GMC**
Model: **Silverado / Sierra**
2500HD, 3500
Engine: **6.6L Duramax "LMM"**

TOOLS REQUIRED

- 10mm Wrench or Socket
- 1/2" Wrench or Socket
- T-20 Security Torx Wrench (Supplied w/ Kit)
- 5/16" Nut Driver or Flat Blade Screwdriver
- Phillips Screwdriver

S&B FILTER OIL

Your Air Filter P/N: KF-1035 is factory oiled and ready to use. When serviced it will require:

- 87g - Main Body
- 17g - Power Stack (Top)

NOTES

Kit may not fit with the following:

- Aftermarket Parts installed
- Body Lift or Lowering Kit
- Custom Hood
- Intercooler or Turbo upgrades

BEFORE YOU START

- Please read the entire product guide before proceeding.
- Ensure all components listed on page 4 are present.
- If you are missing any of the components, call our customer support at (909) 947-0015.
- Do not attempt to work on your vehicle while engine is hot.
- Make sure the engine is turned off and the vehicle is in Park or the Parking Brake is set.

1. With the ignition switched off and the parking brake set, disconnect the negative battery cables on both batteries.



2. Disconnect the electrical connection at the MAF sensor on the OE air box tube.



3. Loosen both hose clamps and remove the OE intake tube from the vehicle.



4. Pull up on the OE air box to remove it from the vehicle, there are two press prongs that go into rubber grommets on the bottom side.

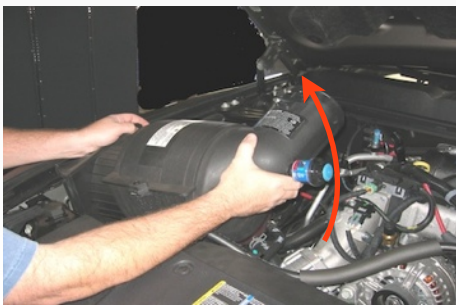

5. Make sure that the OE grommets are still in place in the OE air box tray. They may have pulled out with the air box removal.

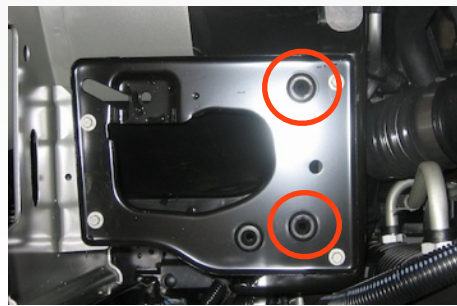

6. Remove the headlight housing bolt in the radiator core support between the passenger side fender and the hood bumper.

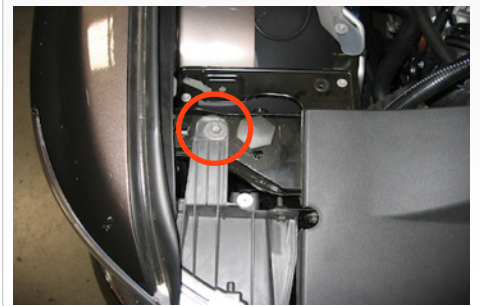

7. Place the Air Filter (P) inside the Air Box (Q), then attach the Filter Adapter (O) clip into the bottom of the Air Box. Secure using the 5/16" bolts (C) & washers (D). Secure the #80 hose clamp (N) at the Filter.



8. Remove the MAF sensor from the OE air box using the supplied T-20 Torx wrench. Make sure the rubber seal stays with the MAF sensor.



9. With the rubber seal in place, insert the MAF sensor into the Filter Adapter (O). Secure the MAF sensor using the supplied M4 screws (H). **Do not over tighten!**



SEE EXPLODED VIEW ON PAGE 4



INSTALLATION INSTRUCTIONS (continued)

10. Test fit the Air box assembly. If there is a clearance issue with the Air Box (Q) it may be necessary to loosen the bolt at the base of the coolant overflow/ reservoir then slide the reservoir back and retighten the bolt.



11. Place the Air box assembly in the vehicle aligning the prongs into the OE grommets.



12. Secure the front of the box using the supplied 6mm Allen Head Bolt (A) and the thin SS Washer (B).



13. Install the Hump Adapter (I) along with the #80 Hose Clamps (N) over the Intake Tube (J). Slide on until it is just about flush with the end of the tube.



14. With a #64 Hose Clamp (K) and a #72 Hose Clamp (L) installed on the Straight Adapter (M), secure the smaller end to the Intake tube (J).



15. Connect the Intake tube assembly to the turbo inlet and secure the #72 Hose Clamp (L). Center the Hump Adapter (I) over the gap between the tube ends and secure both #80 Hose Clamps (N).



16. Reconnect the MAF sensor electrical connection.



17. Install the Clear Lid (G) and secure with the 10/24 screws (E) and SS Sealing Washers (F). **Do not over tighten!**



18. Reconnect both batteries. Inspect your installation, make sure the kit is properly positioned and all fasteners are secure. Affix the CARB sticker near the intake kit. The installation is now complete.



SEE EXPLODED VIEW ON PAGE 4



INSTALLATION INSTRUCTIONS

PRECISION FILTER CLEANING & OILING



Part No. 88-0005

**Order online today at www.sbfilters.com or
through your local S&B distributor.**

RELATED ITEMS FOR YOUR PURCHASE

- Replacement Air Filter (Oiled)
(S&B P/N: KF-1035)
- Replacement Air Filter (Dry)
(S&B P/N: KF-1035D)
- Air Filter Wrap (S&B P/N: WF-1023)

PERFORMANCE TESTING

- Engage parking brake and start your engine. Listen for abnormal noises. If an air leak is detected, re-inspect hoses and connections as they may need to be repositioned and tightened.
- S&B FILTERS recommends that you keep your OE intake system in the event it is required in the future.
- In order to maintain your warranty, all connections and components must be checked periodically for alignment and for proper tension on all connections. Failure to do so may void your warranty.
- Use only S&B FILTERS cleaning and oil products to service your filter. Using any other brand oil and or cleaners on your S&B air filter may void your warranty.

SEE EXPLODED VIEW ON PAGE 4

EMISSIONS STANDARD

The California Air Resource Board (CARB) requires that an E.O. identification label be applied to the vehicle in order to pass a smog check inspection when a Performance Intake Kit has been installed. You must place the E.O. label provided on or near the intake kit after installation so that a smog check technician can easily verify the E.O. number. As of April 2009, S&B has never had a product where CARB denied an exemption request; however, the exemption process with CARB can take as long as 18 months. Check the status of the exemption process by looking up a specific part number at www.sbfilters.com. The CARB Exemption number and/or status is listed under the Product Details section for each part number. If the status shows as "Pending," CARB has yet to issue an exemption. Products that have not been issued an EO number are street legal in most states, but may not be used on emission controlled vehicles in the state of California and are for off road use only. If you purchased your kit from S&B Filters directly, we will automatically mail you your Exemption Sticker when it is issued to us. If you purchased your kit from an authorized S&B Filters Dealer, log onto our web site and register to receive your Exemption Sticker.



EXPLODED VIEW

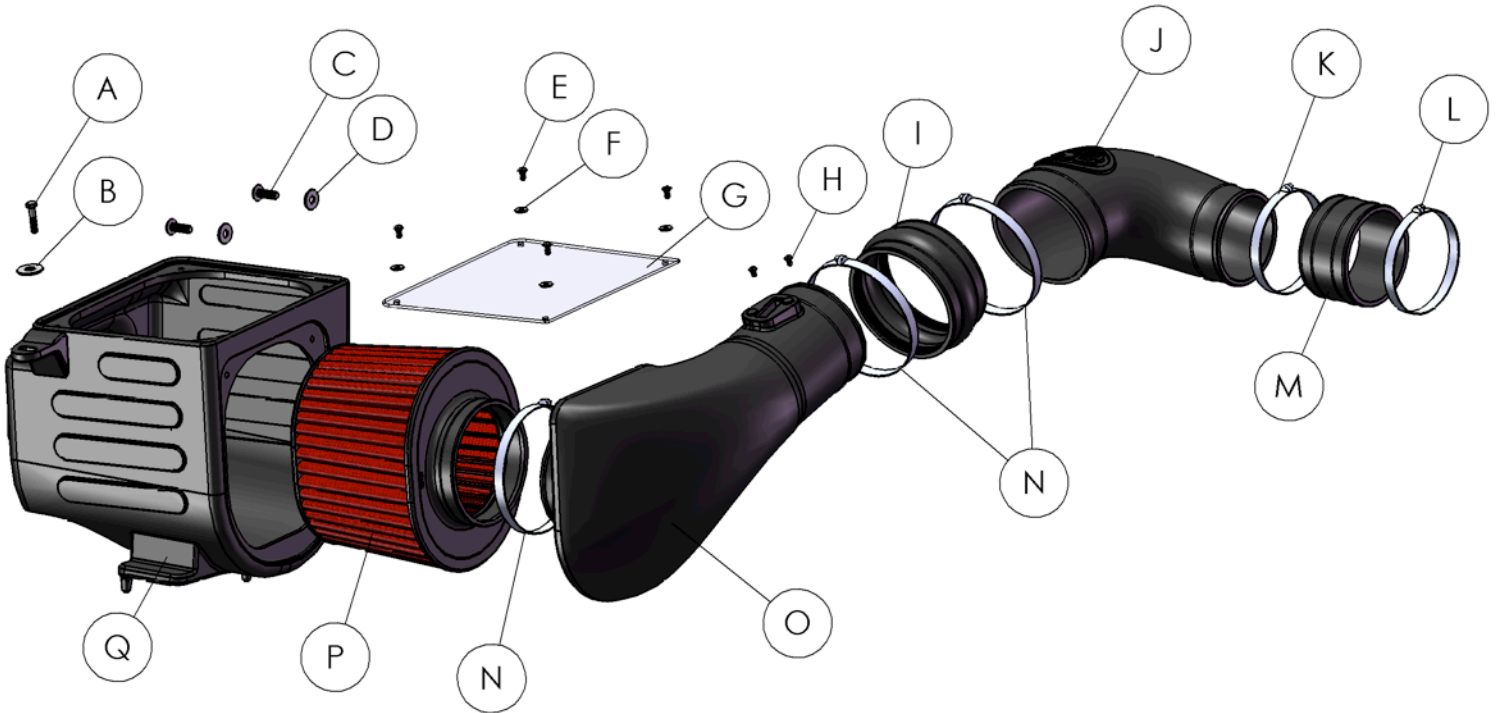

ITEM	QTY.	DESCRIPTION	P/N
A	1	Bolt, Allen Head M6-1.0x30mm	Al1366-00
B	1	Washer, Flat SS, 1.0"OD	Al1341-00
C	2	Bolt, Hex, 5/16-18x1/2"	Al1078-00
D	2	Washer, Fender, 5/16"	Al1080-00
E	4	Screw, Pan Head, 10-24x1/2"	Al1287-00
F	4	Washer, Sealing, #10	Al1272-00
G	1	Clear Lid	Al1359-00
H	2	Screw, Pan Head, M4-7x8mm	Al1360-00
I	1	Hump Adapter, 4.80"ID	Al1312-00
J	1	Intake Tube	AL1078-00
K	1	Hose Clamp, #64	AG1018-00
L	1	Hose Clamp, #72	AG1009-00
M	1	Straight Adapter	Al1354-00
N	3	Hose Clamp, #80	AG1010-00

ITEM	QTY.	DESCRIPTION	P/N
O	1	Filter Adapter	AL1078A-00
P	1	S&B Air Filter	KF-1035
Q	1	Air Box	AL1078B-00
R	1	Security Torx L-Key, TR20	Al1327-00

AM0121-00 Rev.E 06/15/10